



OUR RANGES



S-LINE

Coupé

Space & open

26-29 kts



F-LINE

Iconic

Space +

25-28 kts



X-LINE

Crossover

Space ++

20-24 kts



M-LINE

XXL

Limitless space

8-20 kts

Introduction

M-Line



Unique Selling Points

PRESTIGE M-Line

Outstanding space for total relaxing and entertainment onboard

Catamarans advantage of wide space, natural light and multiple relaxing areas

High efficiency +20% vs monohulls

Lower emissions, lower operating cost

Stability of the catamaran, and a limited beam

Better seakeeping, less motion sickness, easier marina berthing, cost & weight optimized





1

OUTSTANDING SPACE

PRESTIGE

New dimensions in comfort on the water

- New hull base optimizing space onboard
- 130m² / 1400 sqft of living space on the M48

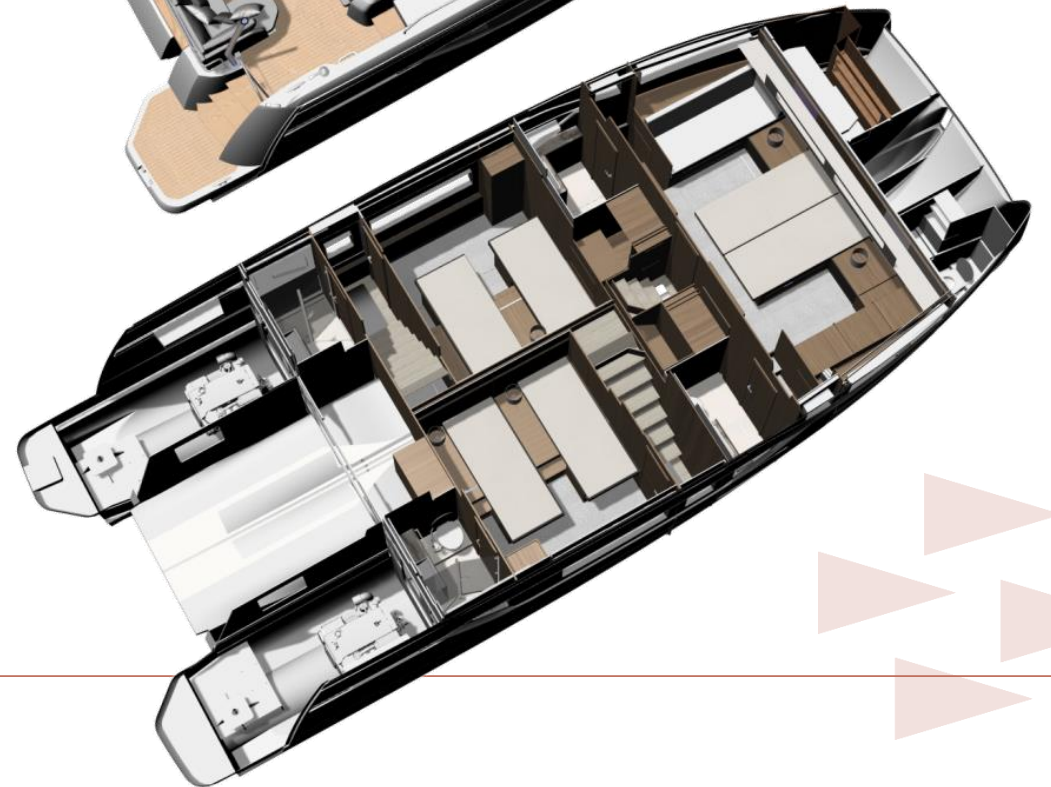
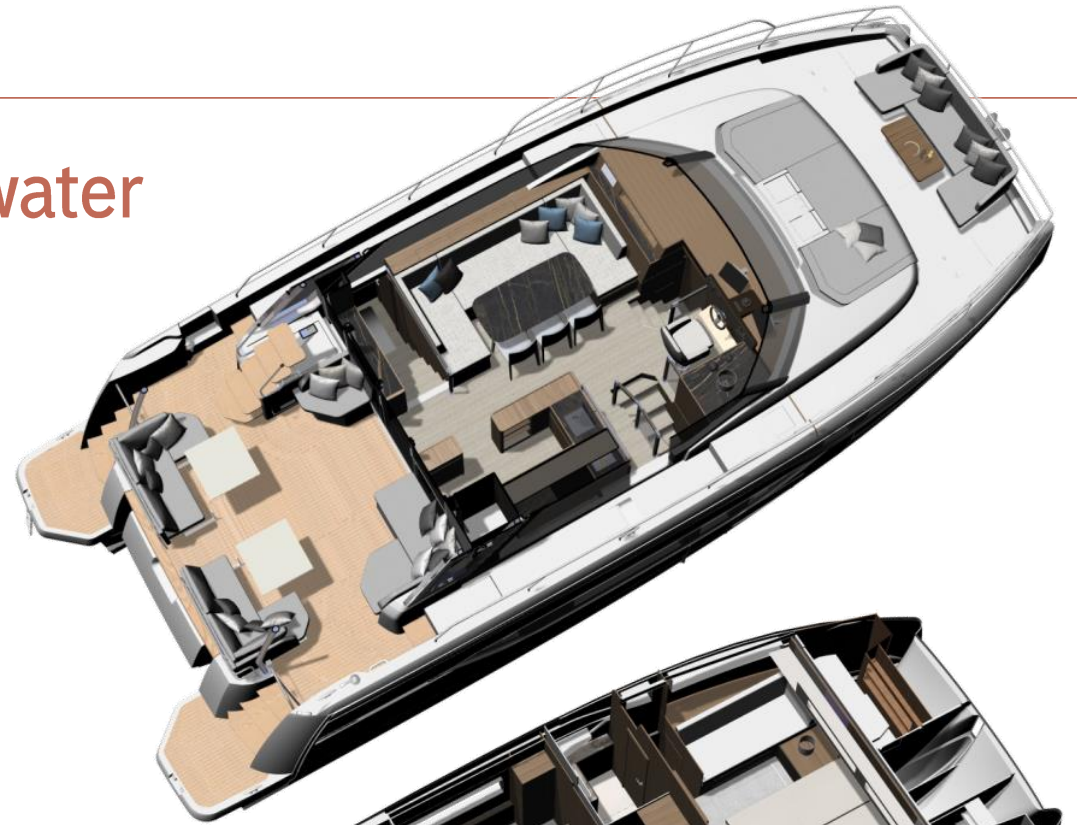



HIGH EFFICIENCY

2

PRESTIGE

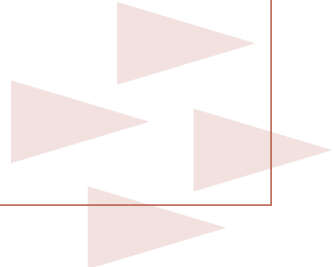

Lower emissions, lower operating cost

- 20 knots top speed
 - 80 liters per hour at 17 knots!
 - 600NM range at 8 knots!
 - M48 offers the benefit to the owners **to choose their cruising speed**
- 



STABILITY

PRESTIGE

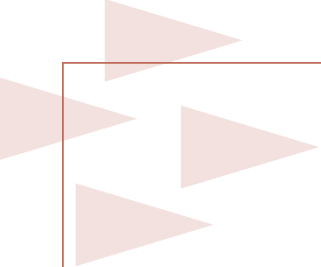
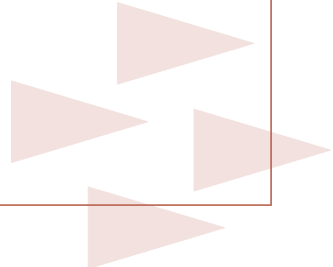
- 
- The architecture of the catamaran provides **natural stability at the anchor**
 - The twin hulls also provide **stability when underway**. No unsafe heeling, the boat remains steady
 - Our M-line beams are below market average for catamarans
- 

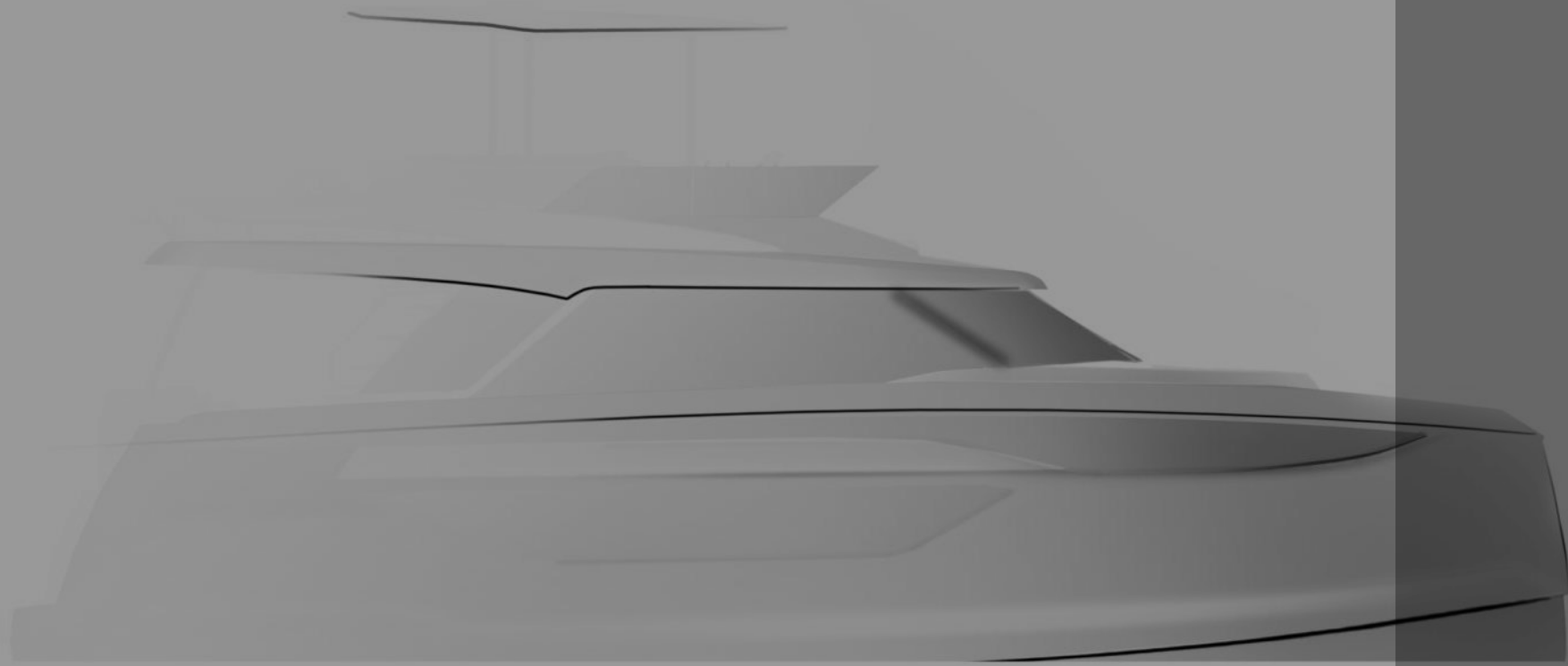

M48

Garroni Design

M48



M48



M48



M48

Hull length	14,05 m 46'1"
LOA	14,79 m 48'6"
Beam	6,00 m 19'8"
Engine	V-Drive Volvo 2x D4 320 hp Joystick
Max speed Cruising speed	20 kts 15 kts – 5 L/NM 8 kts – 2L/NM
Range	250 NM @ 15kts 600 NM @ 8kts
Fuel	1 200 L 317 US gal
Water	600 L 159 US gal
Air draft	Mini: 4,80 m / 15'9" Maxi: 7,48 m / 24'6"
Draft	1,02 m / 3'34"

SPECIFICATIONS

Design: Camillo Garroni

Hull: Philippe Briand

20 m² / 215 sqft living space

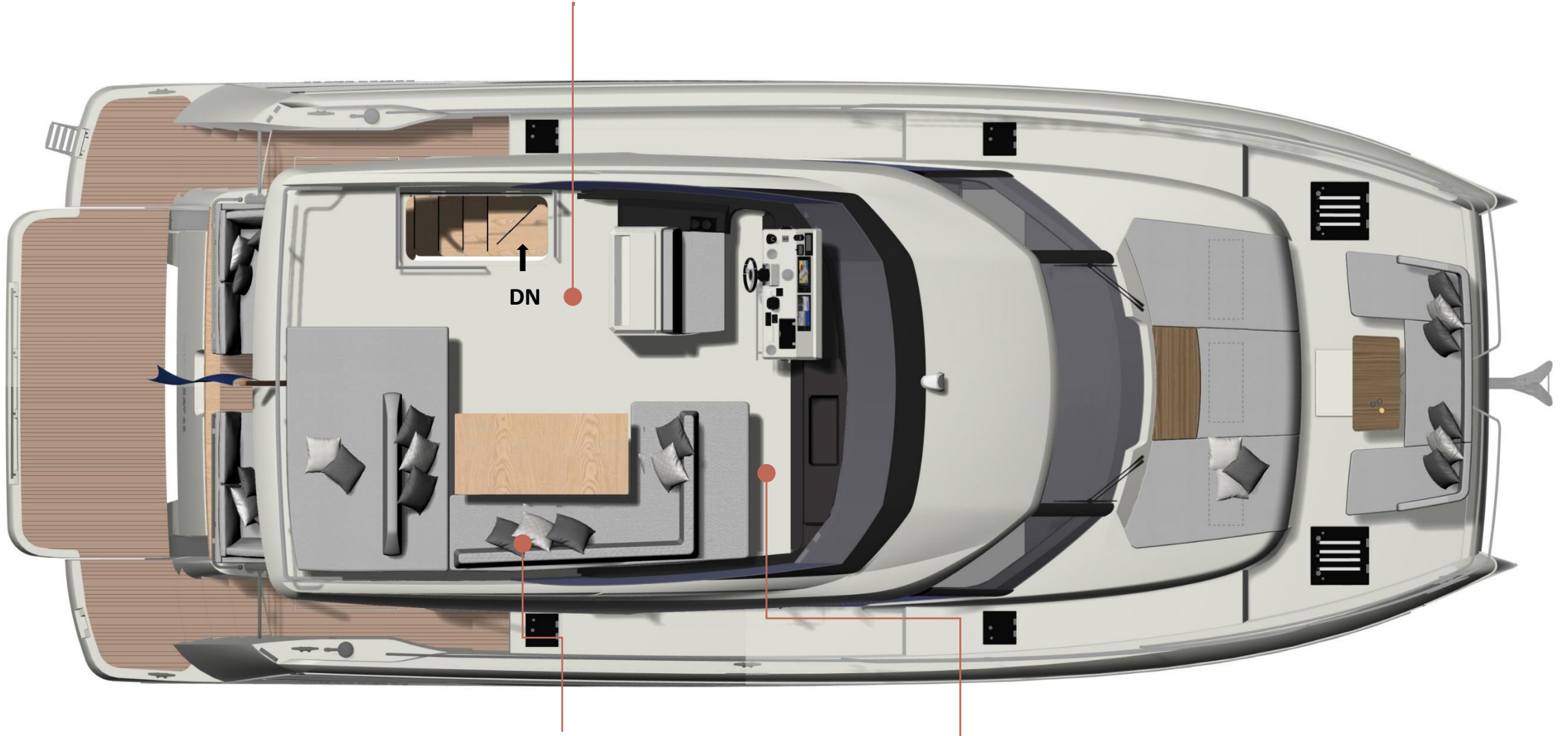

RODA free standing sofa

Optional hardtop

M48

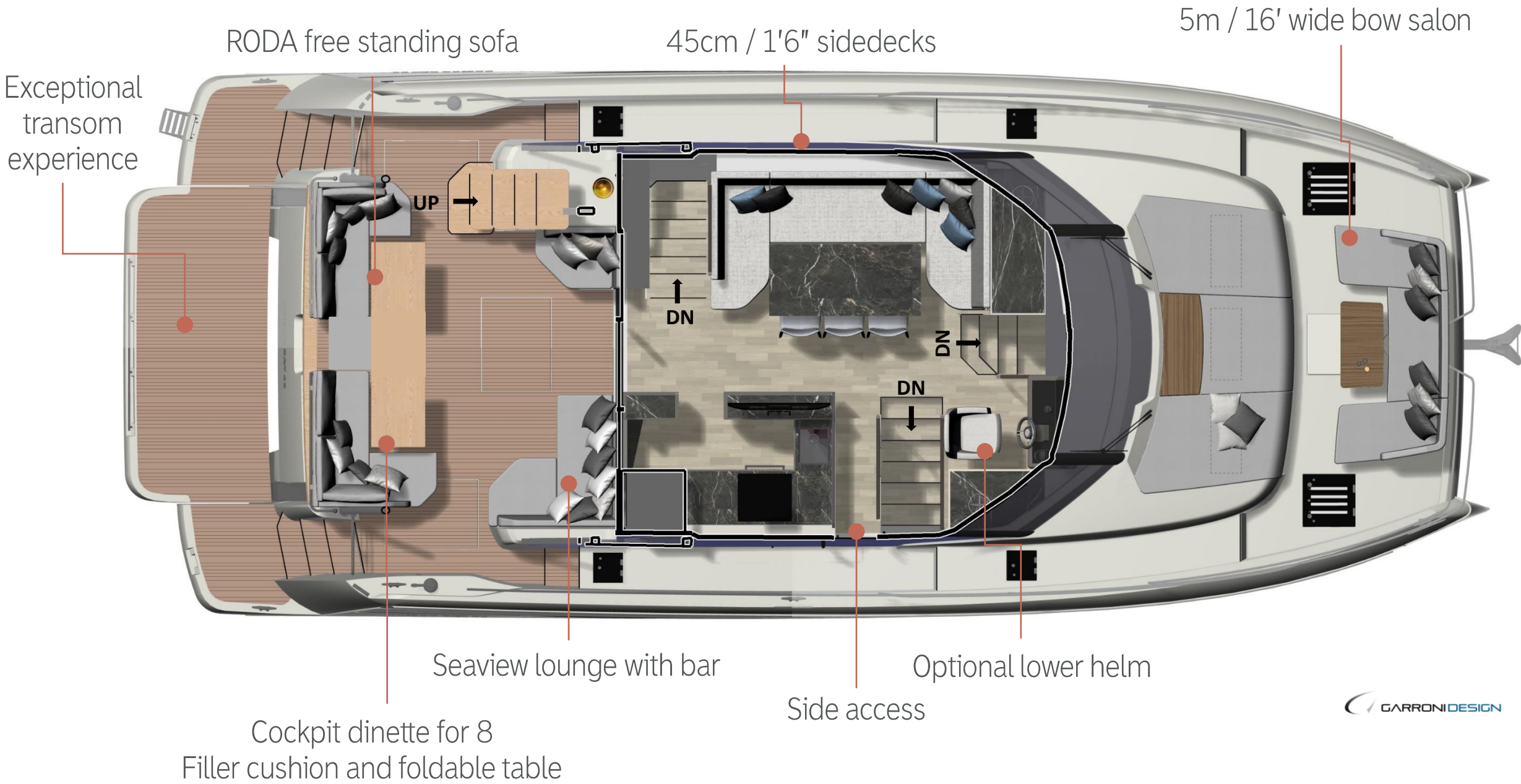



❖ Cockpit terrace and Beach Club area



Toys storage 3m³ capacity



3,50m / 11'6" tender on lifting platform

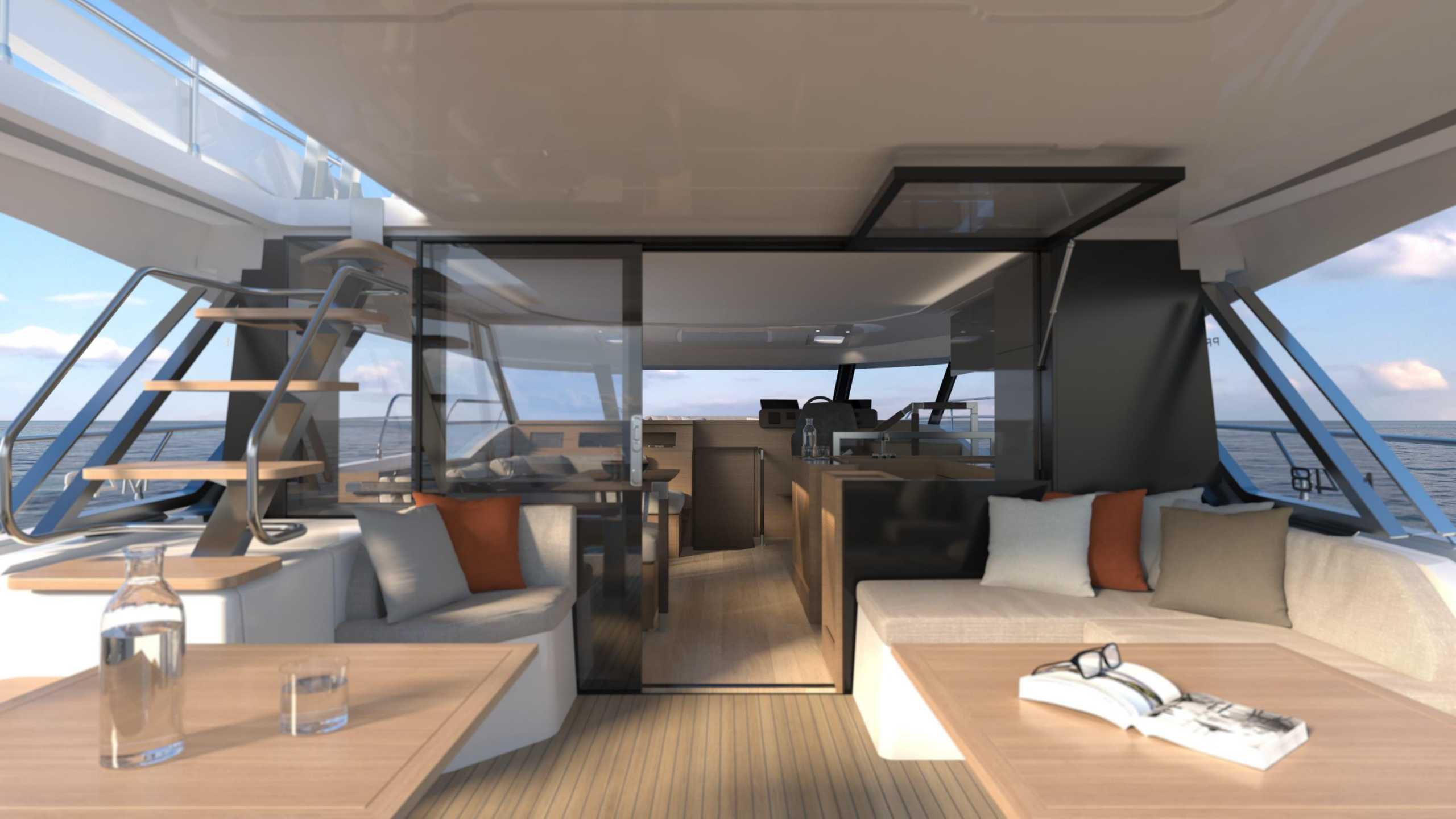

Same space as a 60' monohull







Layout: 3 cabins, 3 bathrooms

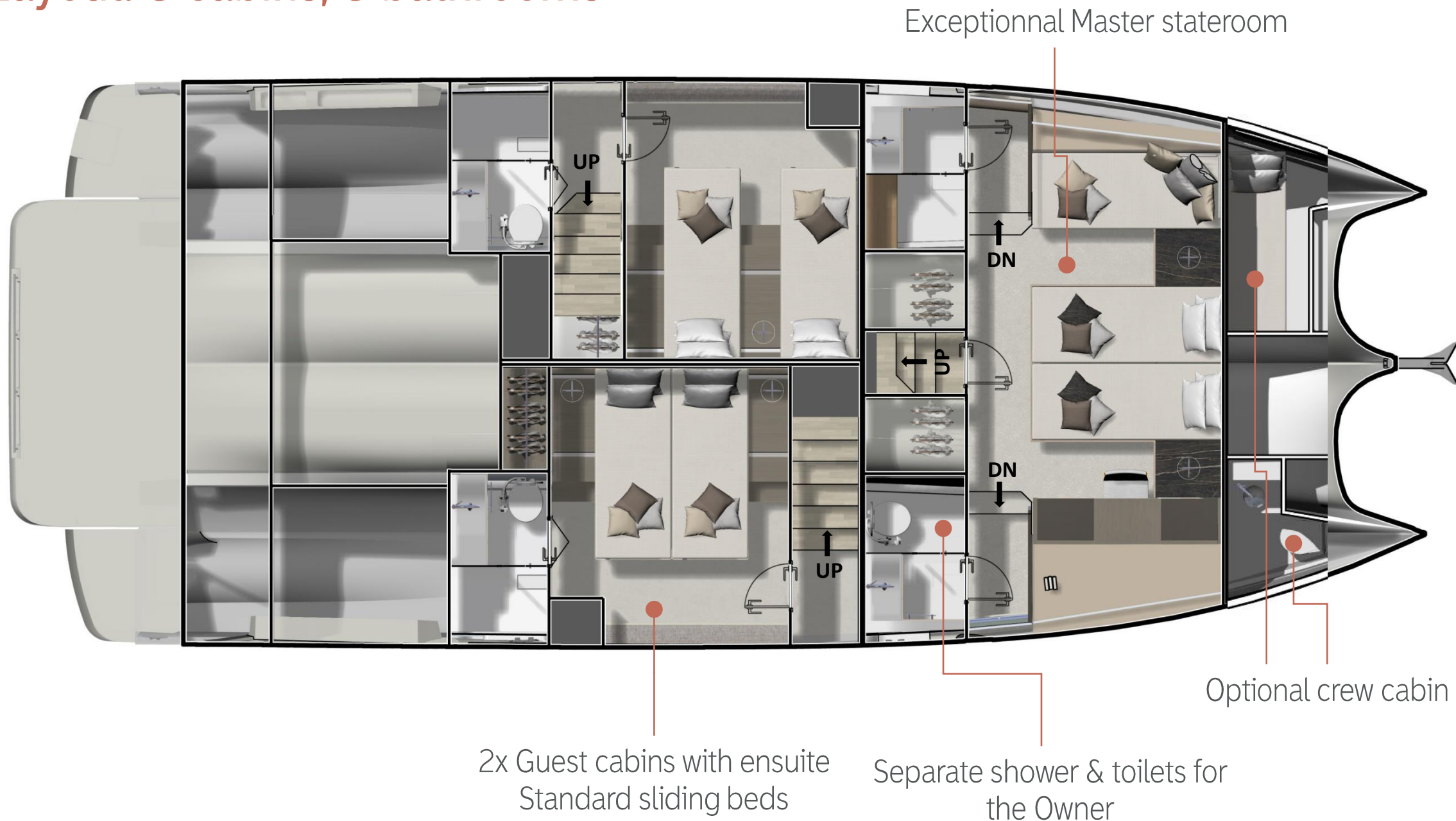

- 5m / 16' wide Owner's suite



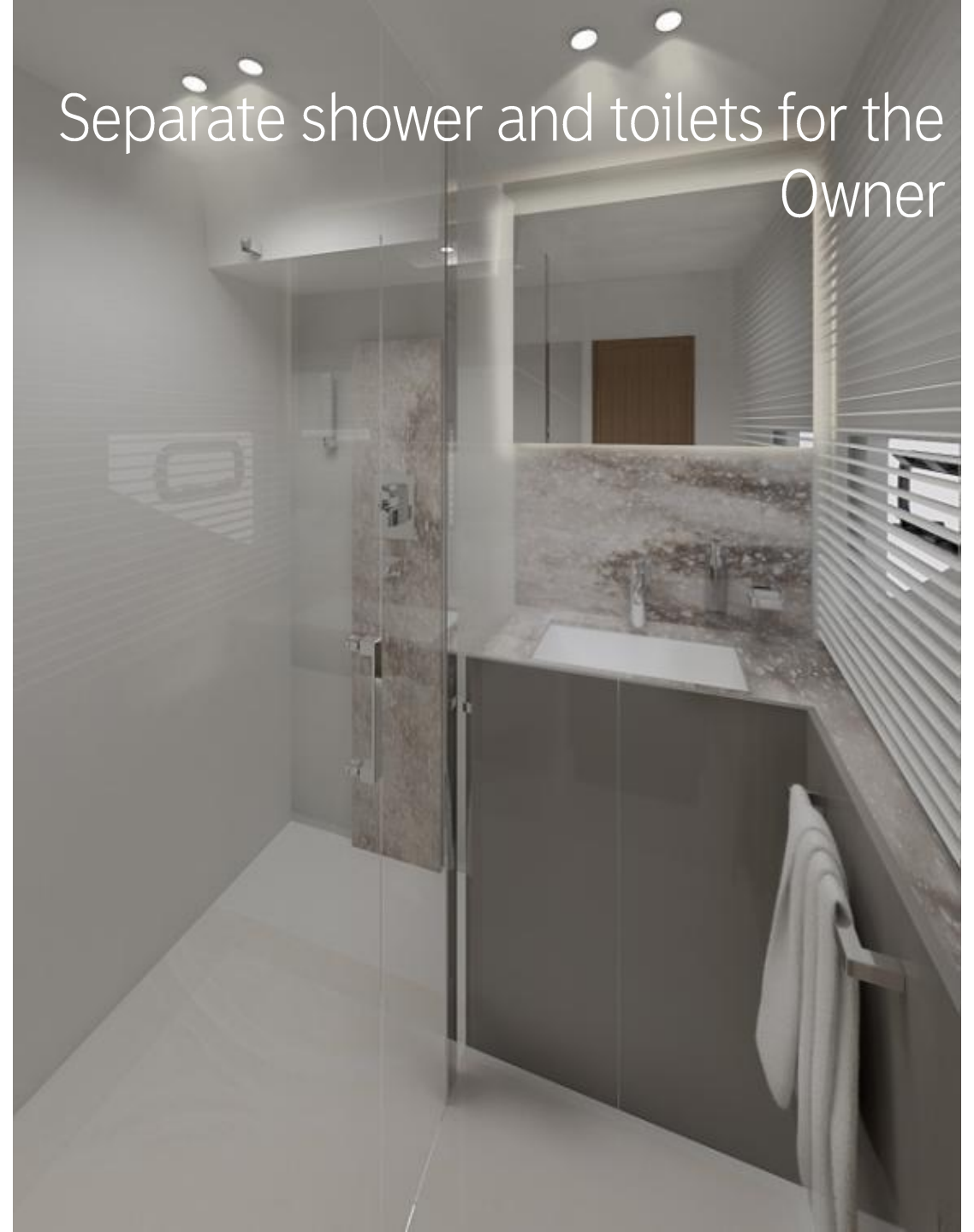

2 symmetric Guest cabins with seaview from the Bed



Optional layout: 4 cabins, 4 bathrooms

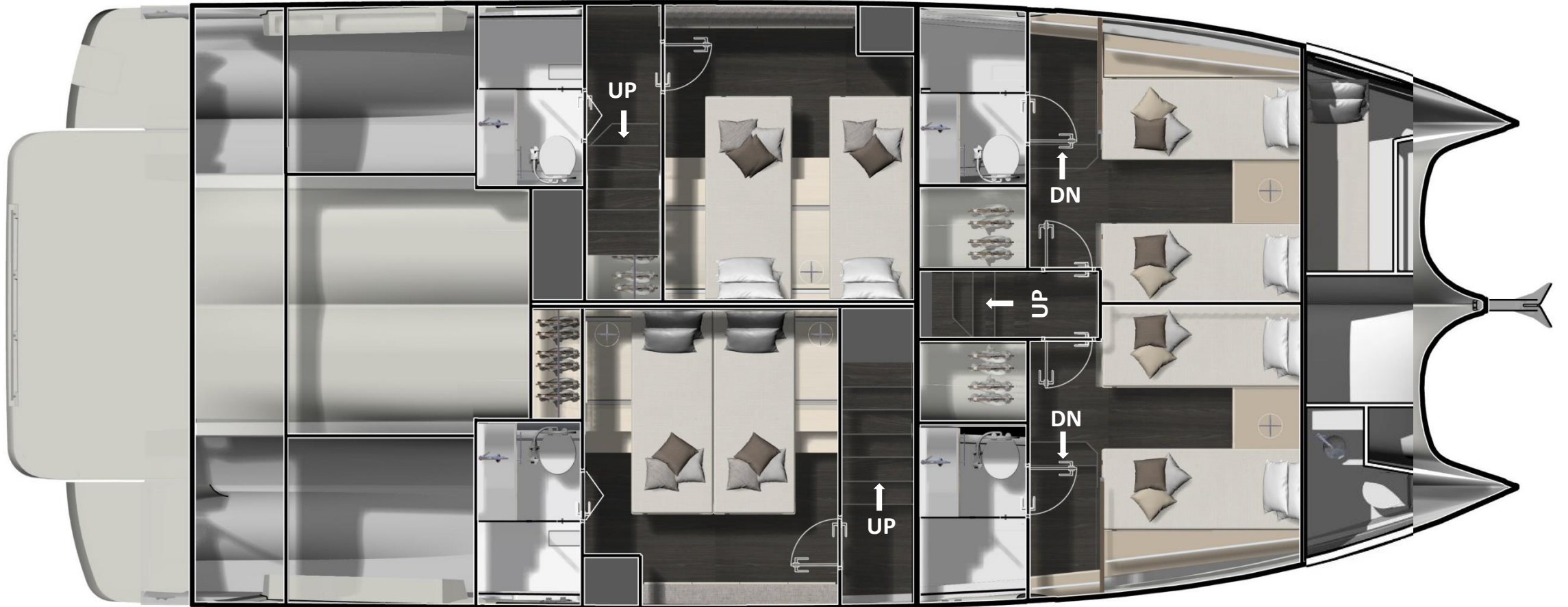

PRESTIGE luxury and quality

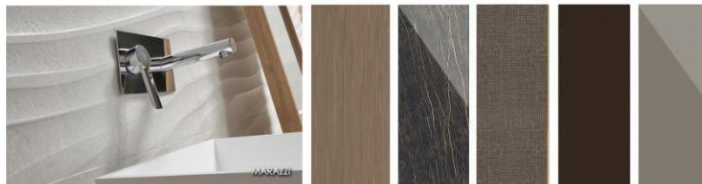

Inspirations

Owner version

Shining wood

Details
Materials
New ambiances

